

SAE-SAEL Heavy Duty Face Fix Hangers

SAE and SAI ranges are heavy-duty hangers designed for applications requiring additional strength. SAE hangers are nailed using square twist nails but have bolt holes for 12mm fasteners into the face. SAE Timber Bolted capacity to be determined according to the relevant standards. The hanger depth is to be at least 60% of the carried member depth to prevent rotation, unless additional lateral restraint is added to the top of the carried member.

Features

Material

Pre-galvanised mild steel

Advantage

- Quick and simple installation

Applications

Header member

- Solid Timber
- I-Joists
- Steel

For Use With

- Solid sawn timber joists
- Purlins

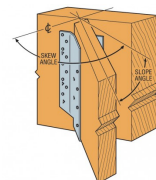
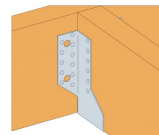
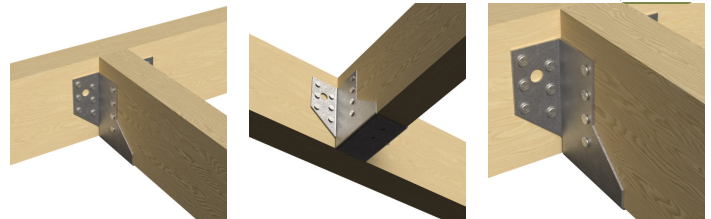

Typical SAE(X) Sloped down, skewed right installation (no bolt holes)

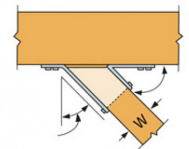

Top view SAE(X) Hanger Skewed right (no bolt holes)

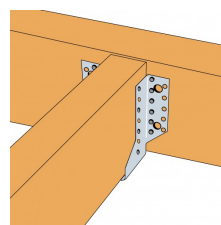

Partial Nailing on Timber

SAE-SAEL
Heavy Duty Face Fix Hangers

Technical Data

Technical data sheet



SAE-SAEL Heavy Duty Face Fix Hangers

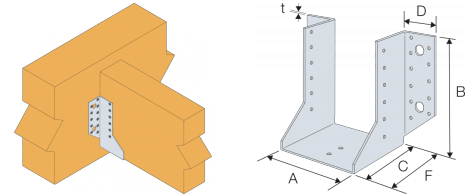

Product Dimensions

References	Joist dimensions [mm]		Product Dimensions [mm]						Header holes			Joist holes	Weight [kg]
	Width		A	B	C	D	F	t	Ø5	Ø11	Ø13	Ø5	
	Min	Max.											
SAE200/38/2	36	38	38	81	84	41.5	86	2	8	2	-	5	0.26
SAE250/38/2	36	38		106	84	41.5	86	2	12	2	-	7	0.33
SAE380/38/2	35	38		171	84	41.5	86	2	20	-	4	10	0.5
SAE500/38/2	35	38		231	84	41.5	86	2	32	-	6	16	0.66
SAE600/38/2	35	38		281	88	36	90	2	36	-	4	20	0.786
SAE200/40/2	38	40	40	80	84	41.5	86	2	8	2	-	5	0.261
SAE250/40/2	38	40		105	84	41.5	86	2	12	2	-	7	0.33
SAE380/40/2	37	40		170	84	41.5	86	2	20	-	4	10	0.49
SAE500/40/2	37	40		230	84	41.5	86	2	32	-	6	16	0.66
SAE600/40/2	37	40		280	88	36	90	2	36	-	4	20	0.786
SAE200/47/2	44	47	47	76.5	88	41.5	90	2	8	2	-	5	0.26
SAE250/47/2	44	47		101.5	88	41.5	90	2	12	2	-	7	0.33
SAE380/47/2	44	47		166.5	84	41.5	86	2	20	-	4	10	0.49
SAE500/47/2	44	47		226.5	84	41.5	86	2	32	-	6	16	0.65
SAE600/47/2	44	47		276.5	88	36	90	2	36	-	4	20	0.786
SAE200/50/2	48	50	50	75	84	41.5	86	2	8	2	-	5	0.26
SAE250/50/2	48	50		100	84	41.5	86	2	12	2	-	7	0.33
SAE500/50/2	48	50		225	84	41.5	86	2	34	-	6	18	0.66
SAE380/50/2	47	50		165	84	41.5	86	2	20	-	4	10	0.49
SAE600/50/2	47	50		275	88	36	90	2	36	-	4	20	0.786
SAE380/56/2	53	56	56	162	84	41.5	86	2	20	-	4	10	0.001
SAE500/56/2	53	56		222	84	41.5	86	2	32	-	6	16	0.66
SAE600/56/2	53	56		272	88	36	90	2	36	-	4	20	0.786
SAE380/63/2	60	63	63	158.5	84	41.5	86	2	20	-	4	10	0.49
SAE500/63/2	60	63		218.5	84	41.5	86	2	32	-	6	16	0.66
SAE600/63/2	60	63		268.5	88	36	90	2	36	-	4	20	0.786
SAE380/66/2	64	66	66	157	84	41.5	86	2	22	-	4	12	0.49
SAE500/66/2	63	66		217	84	41.5	86	2	32	-	6	16	0.66
SAE600/66/2	63	66		267	88	36	90	2	36	-	4	20	0.786
SAE380/72/2	70	72	72	154	84	41.5	86	2	22	-	4	12	0.49
SAE500/72/2	69	72		214	84	41.5	86	2	32	-	6	16	0.66
SAE600/72/2	69	72		264	88	36	90	2	36	-	4	20	0.786
SAE380/75/2	72	75	75	152.5	84	41.5	86	2	20	-	4	10	0.49
SAE500/75/2	72	75		212.5	84	41.5	86	2	32	-	6	16	0.66
SAE600/75/2	72	75		262.5	88	36	90	2	36	-	4	20	0.786
SAE380/78/2	75	78	78	151	84	41.5	86	2	20	-	4	10	0.49
SAE500/78/2	75	78		211	84	41.5	86	2	32	-	6	16	0.66
SAE600/78/2	75	78		261	88	36	90	2	36	-	4	20	0.786
SAE380/91/2	88	91	91	144.5	84	41.5	86	2	20	-	4	10	0.49
SAE500/91/2	88	91		204.5	84	41.5	86	2	32	-	6	16	0.66
SAE600/91/2	88	91		254.5	88	36	90	2	36	-	4	20	0.786
SAE380/96/2	93	96	96	142	84	41.5	86	2	20	-	4	10	0.49
SAE500/96/2	93	96		202	84	41.5	86	2	32	-	6	16	0.66

Technical data sheet



SAE-SAEL Heavy Duty Face Fix Hangers

References	Joist dimensions [mm]		A	Product Dimensions [mm]					Header holes			Joist holes	Weight [kg]
	Width			B	C	D	F	t	Ø5	Ø11	Ø13	Ø5	
	Min	Max.											
SAE600/96/2	93	96		252	88	36	90	2	36	-	4	20	0.786
SAE380/99/2	96	99	99	140.5	84	41.5	86	2	20	-	4	10	0.49
SAE500/99/2	96	99		200.5	84	41.5	86	2	32	-	6	16	0.66
SAE600/99/2	96	99		250.5	88	36	90	2	36	-	4	20	0.786
SAE380/109/2	106	109	109	135.5	84	41.5	86	2	20	-	4	10	0.001
SAE500/109/2	106	109		195.5	84	41.5	86	2	32	-	6	16	0.66
SAE600/109/2	106	109		245.5	88	36	90	2	36	-	4	20	0.786
SAE500/118/2	115	118	118	191	84	41.5	86	2	32	-	6	16	0.66
SAE600/118/2	115	118		241	88	36	90	2	36	-	4	20	0.786
SAE500/122/2	119	122	122	189	84	41.5	86	2	32	-	6	16	0.66
SAE600/122/2	119	122		239	88	36	90	2	36	-	4	20	0.786
SAE500/125/2	122	125	125	187.5	84	41.5	86	2	32	-	6	16	0.66
SAE600/125/2	122	125		237.5	88	36	90	2	36	-	4	20	0.786
SAE500/128/2	125	128	128	186	84	41.5	86	2	32	-	6	16	0.66
SAE600/128/2	125	128		236	88	36	90	2	36	-	4	20	0.786
SAEL500/140/2	138	140	140	180	84	41.5	86	2	32	-	6	16	0.65
SAE500/142/2	139	142	142	179	84	41.5	86	2	32	-	6	16	0.66
SAE600/142/2	139	142		229	88	36	90	2	36	-	4	20	0.786
SAE500/146/2	143	146	146	177	84	41.5	86	2	32	-	6	16	0.66
SAE600/146/2	143	146		227	88	36	90	2	36	-	4	20	0.786
SAEL500/150/2	148	150	150	175	84	41.5	86	2	32	-	6	16	0.65
SAE600/150/2	147	150		225	88	36	90	2	36	-	4	20	0.786
SAE600/182/2	179	182	182	209	88	36	90	2	36	-	4	20	0.825
SAE720/182/2	179	182		269	75	38	77	2	38	-	6	20	0.943
SAE600/196/2	193	196	196	202	88	41.5	90	2	36	-	4	20	0.845
SAE720/196/2	193	196		262	75	38	77	2	38	-	6	20	0.943
SAE590/200/2	197	200	200	195	88	41.5	90	2	30	-	6	20	0.8

Technical data sheet



SAE-SAEL Heavy Duty Face Fix Hangers

Product characteristic capacities - Timber to timber - full nailing

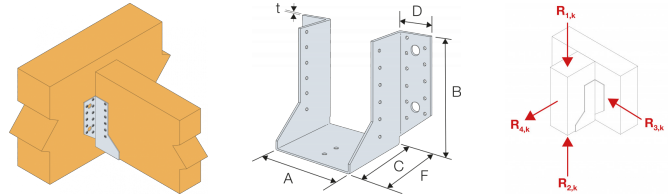

Characteristic capacities - Timber to timber - Full nailing

References	Number of Fasteners		Product characteristic capacities - Timber C24 [kN]			Safe Working Load [kN]		
	Header	Joist	$R_{1,k}$			$R_{2,k}$		
	Qty	Qty	$R_{1,k}$		$R_{2,k}$	$R_{1,SWL,Long\ term}$		$R_{2,SWL,Short\ term}$
			N3.75x30 - C16 Header	N3.75x30 - C24 Header		N3.75x30 - C16 Joist	C16 header N3.75x30	
SAE200/38/2	8	5	7.6	8.1	4.2	3.2	3.4	2.1
SAE250/38/2	12	7	12.7	13.5	5.9	5.3	5.6	3
SAE200/40/2	8	5	7.6	8.1	4.2	3.2	3.4	2.1
SAE250/40/2	12	7	12.7	13.5	5.9	5.3	5.6	3
SAE200/50/2	8	5	7.6	8.1	4.2	3.2	3.4	2.1
SAE250/50/2	12	7	12.7	13.5	5.9	5.3	5.6	3
SAE500/50/2	34	18	33.3	35.6	12.2	13.9	14.8	6.1
SAE380/66/2	22	12	18.2	19.4	8.5	7.6	8.1	4.2
SAE380/72/2	22	12	18.2	19.4	8.5	7.6	8.1	4.2
SAEL500/140/2	32	16	33.3	35.6	12.2	13.9	14.8	6.1
SAEL500/150/2	32	16	33.3	35.6	12.2	13.9	14.8	6.1
SAE380/38/2	20	10	18.2	19.4	8.5	7.6	8.1	4.2
SAE500/38/2	32	16	33.3	35.6	12.2	13.9	14.8	6.1
SAE600/38/2	36	20	42.2	45.1	15.9	17.6	18.8	8.4
SAE380/40/2	20	10	18.2	19.4	8.5	7.6	8.1	4.2
SAE500/40/2	32	16	33.3	35.6	12.2	13.9	14.8	6.1
SAE600/40/2	36	20	42.2	45.1	15.9	17.6	18.8	8.4
SAE200/47/2	8	5	7.6	8.1	4.2	3.2	3.4	2.1
SAE250/47/2	12	7	12.7	13.5	5.9	5.3	5.6	3
SAE380/47/2	20	10	18.2	19.4	8.5	7.6	8.1	4.2
SAE500/47/2	32	16	33.3	35.6	12.2	13.9	14.8	6.1
SAE600/47/2	36	20	42.2	45.1	15.9	17.6	18.8	8.4
SAE380/50/2	20	10	18.2	19.4	8.5	7.6	8.1	4.2
SAE600/50/2	36	20	42.2	45.1	15.9	17.6	18.8	8.4
SAE380/56/2	20	10	18.2	19.4	8.5	7.6	8.1	4.2
SAE500/56/2	32	16	33.3	35.6	12.2	13.9	14.8	6.1
SAE600/56/2	36	20	42.2	45.1	15.9	17.6	18.8	8.4
SAE380/63/2	20	10	18.2	19.4	8.5	7.6	8.1	4.2
SAE500/63/2	32	16	33.3	35.6	12.2	13.9	14.8	6.1
SAE600/63/2	36	20	42.2	45.1	15.9	17.6	18.8	8.4
SAE500/66/2	32	16	33.3	35.6	12.2	13.9	14.8	6.1
SAE600/66/2	36	20	42.2	45.1	15.9	17.6	18.8	8.4
SAE500/72/2	32	16	33.3	35.6	12.2	13.9	14.8	6.1
SAE600/72/2	36	20	42.2	45.1	15.9	17.6	18.8	8.4
SAE380/75/2	20	10	18.2	19.4	8.5	7.6	8.1	4.2
SAE500/75/2	32	16	33.3	35.6	12.2	13.9	14.8	6.1
SAE600/75/2	36	20	42.2	45.1	15.9	17.6	18.8	8.4
SAE380/78/2	20	10	18.2	19.4	8.5	7.6	8.1	4.2
SAE500/78/2	32	16	33.3	35.6	12.2	13.9	14.8	6.1
SAE600/78/2	36	20	42.2	45.1	15.9	17.6	18.8	8.4
SAE380/91/2	20	10	18.2	19.4	8.5	7.6	8.1	4.2

Technical data sheet



SAE-SAEL Heavy Duty Face Fix Hangers

References	Characteristic capacities - Timber to timber - Full nailing							
	Number of Fasteners		Product characteristic capacities - Timber C24 [kN]			Safe Working Load [kN]		
	Header	Joist	R _{1,k}		R _{2,k}	R _{1,SWL,Long term}		R _{2,SWL,Short term}
	Qty	Qty	N3.75x30 - C16 Header	N3.75x30 - C24 Header	N3.75x30 - C16 Joist	C16 header N3.75x30	C24 header N3.75x30	C16 Joist N3.75x30
SAE500/91/2	32	16	33.3	35.6	12.2	13.9	14.8	6.1
SAE600/91/2	36	20	42.2	45.1	15.9	17.6	18.8	8.4
SAE380/96/2	20	10	18.2	19.4	8.5	7.6	8.1	4.2
SAE500/96/2	32	16	33.3	35.6	12.2	13.9	14.8	6.1
SAE600/96/2	36	20	42.2	45.1	15.9	17.6	18.8	8.4
SAE380/99/2	20	10	18.2	19.4	8.5	7.6	8.1	4.2
SAE500/99/2	32	16	33.3	35.6	12.2	13.9	14.8	6.1
SAE600/99/2	36	20	42.2	45.1	15.9	17.6	18.8	8.4
SAE380/109/2	20	10	18.2	19.4	8.5	7.6	8.1	4.2
SAE500/109/2	32	16	33.3	35.6	12.2	13.9	14.8	6.1
SAE600/109/2	36	20	42.2	45.1	15.9	17.6	18.8	8.4
SAE500/118/2	32	16	33.3	35.6	12.2	13.9	14.8	6.1
SAE600/118/2	36	20	42.2	45.1	15.9	17.6	18.8	8.4
SAE500/122/2	32	16	33.3	35.6	12.2	13.9	14.8	6.1
SAE600/122/2	36	20	42.2	45.1	15.9	17.6	18.8	8.4
SAE500/125/2	32	16	33.3	35.6	12.2	13.9	14.8	6.1
SAE600/125/2	36	20	42.2	45.1	15.9	17.6	18.8	8.4
SAE500/128/2	32	16	33.3	35.6	12.2	13.9	14.8	6.1
SAE600/128/2	36	20	42.2	45.1	15.9	17.6	18.8	8.4
SAE500/142/2	32	16	33.3	35.6	12.2	13.9	14.8	6.1
SAE600/142/2	36	20	42.2	45.1	15.9	17.6	18.8	8.4
SAE500/146/2	32	16	33.3	35.6	12.2	13.9	14.8	6.1
SAE600/146/2	36	20	42.2	45.1	15.9	17.6	18.8	8.4
SAE600/150/2	36	20	42.2	45.1	15.9	17.6	18.8	8.4
SAE600/182/2	36	20	42.2	45.1	15.9	17.6	18.8	8.4
SAE720/182/2	38	20	44.6	47.6	16.7	18.6	19.8	8.4
SAE600/196/2	36	20	42.2	45.1	15.9	17.6	18.8	8.4
SAE720/196/2	38	20	44.6	47.6	16.7	18.6	19.8	8.4
SAE590/200/2	30	20	29.4	31.4	16.7	12.3	13.1	8.4

SAE-SAEL Heavy Duty Face Fix Hangers

Product characteristic capacities - Timber to timber - with connector screw SSH

References	Product capacities - Timber to Timber - with connector screw SSH											
	Number of Fasteners				Characteristic capacities - Timber C24 [kN]							
	Header		Joist		R _{1,k}		R _{2,k}		R _{3,k}		R _{4,k}	
	Qty	Type	Qty	Type	CNA4.0x35	CNA4.0x50	CNA4.0x35	CNA4.0x50	CNA4.0x35	CNA4.0x50	CNA4.0x35	CNA4.0x50
SAE200/2X	2	SSH10.0x40	5	CNA*	5.6	6.3	5.7	6.4	2.1	3.6	5	5
SAE250/2X	2	SSH10.0x40	7	CNA*	7	7.2	6.9	7.2	2	2.7	5	5
SAE380	4	SSH12.0x60	12	CNA*	18.4	21	18.4	21	3.8	5.6	10	10
SAE500	6	SSH12.0x60	18	CNA*	27.7	33.4	27.7	33.4	4.5	6.5	15	15

Transversal tension shall be checked by the user and may govern.

These values are valid if the following minimum distances from SSH screws to edges are fulfilled:

Screw	Min. distance to loaded edge a _{2,c}	Min. distance to unloaded edge a _{2,c}
SSH10.0	50	40
SSH12.0	80	40

for lower distances, check ETA-06/0270 and EN1995.

The minimum thickness of the supporting timber member to use with SSH10x40 is 47 mm and for SSH12x60 is 75 mm.

For values with other SSH length, please refer to the ETA-06/0270

SAE-SAEL Heavy Duty Face Fix Hangers

Installation

Fasteners

- Install using 3.75 x 30mm square twist nails

Installation

The hanger depth is to be at least 60% of the carried member depth to prevent rotation, unless additional lateral restraint is added to the top of the carried member.

- **SAE hangers have bolt holes for 12mm fasteners if required**
- **SAE timber bolted capacity to be determined according to the relevant standards**

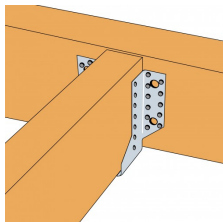

Full Nailing on Timber

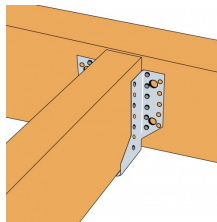

Partial Nailing on Timber

